

Flomatic Plus RPZ Device Less Adaptors

Series: PP-FLO-RPZ

Size: DN15-DN50

Flomatic Plus Reduced Pressure Zone Devices are designed to protect potable water supplies in accordance with national plumbing codes and water authority requirements. This series can be used in a variety of installations, including the prevention of health hazard cross-connections in piping systems or for containment at the service line entrance.

This series features two in-line, independent check valves, captured springs and replaceable check seats with an intermediate relief valve. Its compact modular design facilitates easy maintenance and assembly access.

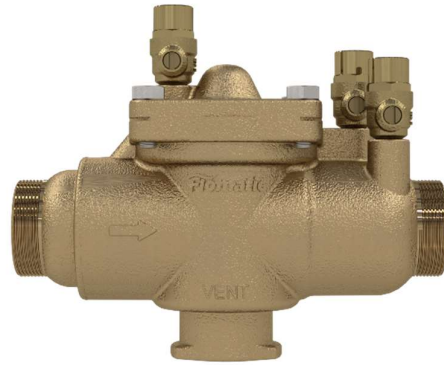

KEY FEATURES

- DN15-50mm sizes (1/2"-2") to suit wide range of installations
- Lead-free* materials for safer water (NCC Vol 3)
- Interchangeable union ball valve and strainer combinations
- Reduce assembly time and leak points with combined ball valve and strainer
- Lightweight and compact construction for easy installation
- Convenient in-line servicing with top access cover and no special tools required
- Easy check valve servicing with captured springs
- Lockable ball valves and tamper proof test cocks
- Low pressure drop flow passage
- Durable bronze body with PN16 rating
- Watermark approved for AS/NZS 2845.1 (Device) and WMTS-012 (Ball Valves)

* $\leq 0.25\%$ lead content according to NSF / ANSI / CAN 372

CERTIFICATE



- **Device:** AS/NZS 2845.1 WM22155
- **Ball Valves:** WMTS-012 WM26080

PRODUCT CODES

PP-FLO-RPZ-15-20-25	15-20-25 RPZ Device Flomatic Plus Less Adaptors
PP-FLO-RPZ-32-40-50	32-40-50 RPZ Device Flomatic Plus Less Adaptors

An Adaptor Set or Ball Valve Kit is required to install the RPZ device. Refer to the product table below

PP-FLO-DCV-RPZ-015-ADPT	15mm DCV- RPZ Flomatic Plus Adaptor Set (Fits DN15/20/25 Device)
PP-FLO-DCV-RPZ-020-ADPT	20mm DCV- RPZ Flomatic Plus Adaptor Set (Fits DN15/20/25 Device)
PP-FLO-DCV-RPZ-025-ADPT	25mm DCV- RPZ Flomatic Plus Adaptor Set (Fits DN15/20/25 Device)
PP-FLO-DCV-RPZ-032-ADPT	32mm DCV- RPZ Flomatic Plus Adaptor Set (Fits DN32/40/50 Device)
PP-FLO-DCV-RPZ-040-ADPT	40mm DCV- RPZ Flomatic Plus Adaptor Set (Fits DN32/40/50 Device)
PP-FLO-DCV-RPZ-050-ADPT	50mm DCV- RPZ Flomatic Plus Adaptor Set (Fits DN32/40/50 Device)

PP-FLO-ULBS-15-FIT-KIT	15mm Flomatic Plus ULBS Ball Valve Kit (Fits DN15/20/25 Device)
PP-FLO-ULBS-20-FIT-KIT	20mm Flomatic Plus ULBS Ball Valve Kit (Fits DN15/20/25 Device)
PP-FLO-ULBS-25-FIT-KIT	25mm Flomatic Plus ULBS Ball Valve Kit (Fits DN15/20/25 Device)
PP-FLO-ULBS-32-FIT-KIT	32mm Flomatic Plus ULBS Ball Valve Kit (Fits DN32/40/50 Device)
PP-FLO-ULBS-40-FIT-KIT	40mm Flomatic Plus ULBS Ball Valve Kit (Fits DN32/40/50 Device)
PP-FLO-ULBS-40-FIT-KIT	40mm Flomatic Plus ULBS Ball Valve Kit (Fits DN32/40/50 Device)

Flomatic Plus RPZ Device Less Adaptors

Series: PP-FLO-RPZ

Size: DN15-DN50

TECHNICAL DATA

Minimum Operating Temperature	0.5°C
Maximum Operating Temperature	80°C
Maximum Working Pressure	1600kPa
Body Material	Lead-Free DR Bronze
Test Cock Material	Lead-Free DR Brass
Checks Material	Polymer
Check Seat Material	Silicone Rubber Disc

Spring Material	Stainless Steel
Relief Valve Seat Material	Stainless Steel
Cover Material	Lead-Free* DR Bronze
Cover Bolt Material	Stainless Steel
Inlet Connection	Male BSP
Outlet Connection	Male BSP
Working Medium	Non corrosive liquids

IMENSION DATA

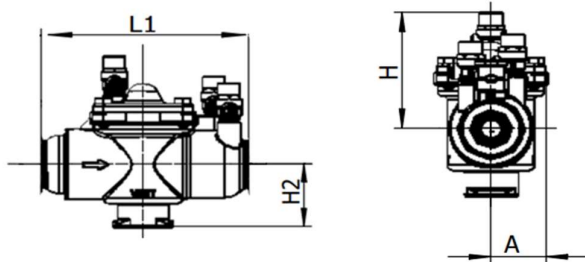

Size	A	H	H2	L1
DN15	42	96.2	55.7	184
DN20	42	96.2	55.7	184
DN25	42	96.2	55.7	184
DN32	73.6	120.9	83.8	278.4
DN40	73.6	120.9	83.8	278.4
DN50	73.6	120.9	83.8	278.4

CHARACTERISTIC CURVES

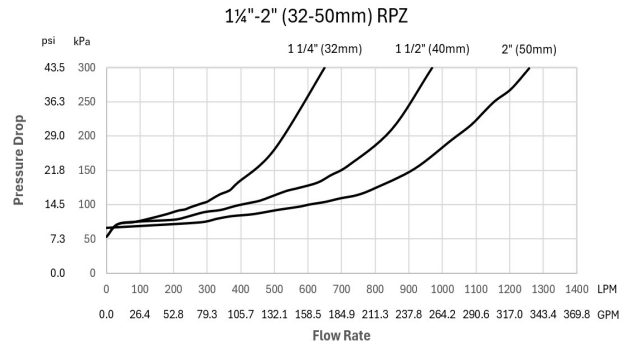
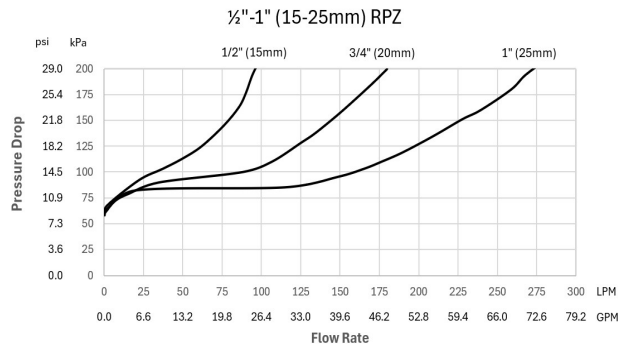

SPARE PARTS

PP-FLO-RPZ-15-25-CK1	First Check Valve for DN15/20/25 RPZ
PP-FLO-RPZ-32-50-CK1	First Check Valve for DN32/40/50 RPZ
PP-FLO-RPZ-15-25-CK2	Second Check Valve for DN15/20/25 RPZ
PP-FLO-RPZ-32-50-CK2	Second Check Valve for DN32/40/50 RPZ
PP-FLO-RPZ-15-25-RV	Relief Valve Repair Kit for DN15/20/25 RPZ
PP-FLO-RPZ-32-50-RV	Relief Valve Repair Kit for DN32/40/50 RPZ
PP-FLO-RPZ-15-25-T	Total Repair Kit for DN15/20/25 RPZ (Includes First Check, Second Check, Relief Valve, Spring and Seat)
PP-FLO-RPZ-32-50-T	Total Repair Kit for DN32/40/50 RPZ (Includes First Check, Second Check, Relief Valve, Spring and Seat)

TYPICAL INSTALLATION

The information contained herein is not intended to replace the full product installation and safety information available or the experience of a trained product installer. You are required to thoroughly read all installation instructions and product safety information before beginning the installation of this product. Inquire with governing authorities for local installation requirements.

Every care has been taken in the preparation of these instructions, which have been issued as a guide only. Compliance with the requirements of local Authorities is required at all times. These requirements may change from time to time. Always be aware of the local requirements. Subject to any statutory obligations and manufacturers warranties no liability can be accepted for any losses, consequential or otherwise which may arise or be said to have arisen from relying upon the contents of this information as to the fitness of any particular product for any particular purpose, use or application. Watts Australia Pty Ltd reserves the right to modify designs and specifications and to withdraw and introduce products at any time without notice.