

# ZUCCHETTI.

## INSTALLATION INSTRUCTIONS

Dear Customer,

**Congratulations** on your purchase of a Zucchetti Mixer. This tap has been manufactured, with the utmost care, to meet the highest Australian and International standards and will serve you reliably for many years to come.

The mixer is covered by a 5 year guarantee as specified below. Please retain your receipt as proof of the purchase date.

Before connecting the mixer, please take the time to read these installation and fitting instructions.

### GUARANTEE

The 5 year warranty covers the following cases:

1. Casting, porosity and chromium plating defects
2. Repair or replacement of pieces with manufacturing defects recognised by our technical department
3. the ceramic disc cartridge is guaranteed against leaking or dripping

### TERMS

The warranty is effective as at the date of purchase.

Your Zucchetti agent reserves the right to assess, fix, replace or service any warranty claim as they see fit

Failure to comply with the installation and maintenance instructions will void warranty

Please retain your receipt as proof of purchase date.

Blocked or damaged aerators are not covered under the warranty

Hand sprays and hoses are guaranteed for 2 years



## MAINTENANCE OF THE MIXER

**CLEANING**— The chromium, gold plated and coloured surfaces should only be cleaned with soap and water, applied with a **soft** sponge or cloth. Do not use any detergents containing hydrochloric acid or abrasives (this includes cream cleansers). The aerator, located at the outlet, should be checked and cleaned at regular intervals.

**MAINTENANCE**— Should service be required on your mixer, please contact the distributor in your state. These are listed on the back of this instruction manual.

## GENERAL INSTALLATION INSTRUCTIONS

This tapware is to be used on equal pressure hot and cold water. Mains pressure hot water systems and instantaneous hot water systems are suitable.

Minimum Operating Pressure 170kpa (25psi)

Maximum Operating Pressure 500kpa (72 psi)

**N.B. If pressure above 500kpa then pressure reduction valves need to be installed to insure best operation and long life performance.**

Maximum hot water temperature is 75 Deg Celsius. Hot water systems which have uncontrolled maximum temperatures or exceed maximum recommended temperature, i.e solar or wet bank, must be fitted with tempering valves.

Pipe work must be flushed out before connecting the mixer.

We do not require stop taps to be installed with the mixer (although they may be useful). However, please check with your local authorities as some may require these to be fitted.

Brazing or silver soldering directly onto any mixer is not recommended as the excessive heat will cause permanent damage to it. When operating the mixer for the first time after installation, remove aerator to avoid damage to it by debris coming through the pipe work.

Product sold in Australia and New Zealand must be installed in accordance with the requirements of the AS/NZS 3500 series.

Commissioning of the installed product ensures continuation of compliance with AS/NZS 6400 including that any flow controllers fitted as part of the tap outlet are tightened to prevent removal by hand.

## MOUNTING INSTRUCTIONS FOR SINK/BASIN AND BIDET MIXERS

1. The hole in the sink or countertop (1) must be 35mm diameter
2. The moulded rubber stepped seal (2) sits between the mixer body and the top of the sink or countertop
3. Place mixer in the hole, ensuring that the hot water inlet (indicated with red marking on the underside of mixer) is to the left when facing mixer.
4. Fit horse shoe shaped rubber washer (3), fixing jaw (4) and nut (5).
5. Align mixer body so that the handle rotates at equal angles from left to right in conjunction with the sink or basin.
6. Tighten nut (5) with 12mm socket or tube spanner. If mixer has pop up waste system, refer below before next step.
7. Connect inlet tails to 1/2" male thread using washers supplied (6)

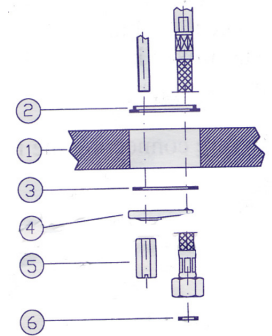

## INSTALLATION INSTRUCTIONS FOR POP UP WASTE SYSTEM

1. Attach mixer as per mounting instructions for bidet mixers (above). Ensure that the threaded rod is touching the front of the hole in the bidet.
2. Slide top half of the vertical popup waste rod (1) through the hole in the back of the mixer until the knob (1) sits flush against the mixer. **If supplied** screw lower half of the vertical rod (2) onto the upper half of the rod (1).
3. When installing the waste outlet, ensure washer (3) sits between the top part of waste outlet (4) and the bidet.
4. Place top part of waste outlet (4) in the bidet hole. Slide bottom seal (5) (flat side facing down) over thread of waste outlet (4). Screw on bottom part of waste outlet (6) until tight (ensure the hole for horizontal rod is facing towards back of bidet).
5. Push nylon friction sleeve (7) into the hole, push in horizontal rod (8) and screw on nut (9). The lever action should not be tight but only firm enough to form a water tight seal.
6. Move the horizontal rod (8) so that the exposed end is in the furthestmost downward position.
7. Slide right angle connector (10), using larger hole, onto horizontal rod (8) until approximately in line with the vertical rod (2). Lift vertical rod and slide into remaining hole in right angle connector (10). Push vertical rod down until the knob (1) is flush against the back of the mixer and lock connector (10) by tightening the screw.
8. Insert plug (11) into waste outlet (4). The plug should sit in the hole to form a seal when the vertical rod knob (1) is pulled up. To adjust the height of the plug (11) turn the screw on the bottom of the plug. When correct height is set, tighten the brass nut to lock screw in place. **The horizontal rod may pass through the eyelet or sit under the base of the screw.**
9. Install bidet, connect mixer to water supply and attach waste to trap using the adaptor supplied.

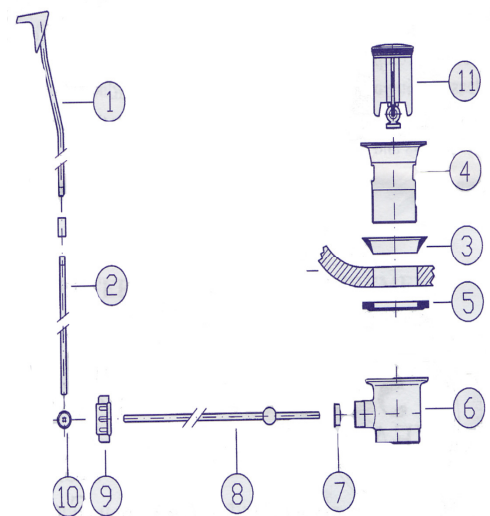

## MOUNTING INSTRUCTIONS FOR SINK MIXERS WITH PULLOUT SPRAY

1. The hole in in the countertop/sink 35mm
2. Connect hose to spray (2) with conical end (1) inserting the washer (3a).
3. Push the hose (1) into the spout body and pull it through the bottom of the mixer.
4. Place the mixer in the sink or countertop hole ensuring that the rubber stepped seal (4) is placed between the mixer body and the sink. For the hose sliding action to operate properly, make sure that the threaded bolt (5) touches the back edge of the hole (Fig. A)
5. Install the **thick** rubber washer (7), the plastic plate (6) (**both to be used for stainless steel sinks only**) and the horseshoe shaped rubber washer (8) over the supply pipes and hose and fasten the mixer using the fixing jaw (9) (**with flat side facing up**) and the hexagonal nut (10) to be tightened on the bolt (5) using a 14mm **tube** spanner. Ensure that the mixer body is aligned so that the handle rotates at equal angles from left to right in conjunction with the sink.  
**NB. The plastic plate (6) needs to sit flush hard up against the sink. Trimming the plate to fit may be required in order to achieve this.**

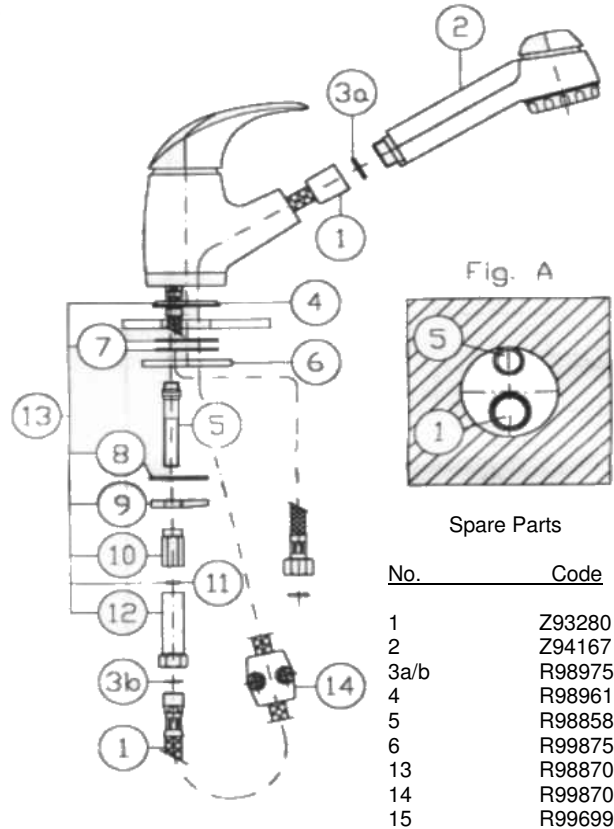

6. Connect the lower end of the hose (1) to the adapter (12) inserting the rubber washer (3b) between the two. Use a 13 mm spanner.
7. Insert the copper washer (11) into the adapter (12) and tighten it firmly to the bolt (5) using an 18mm spanner.
8. Fix the weight pieces (14) to the hose (1) approximately 70 cm from the conical hose end.
9. Connect flexible supply pipes to 1/2" male thread using washers supplied. Hot water inlet is marked with a red indicator on the underside of the mixer. (**For new dwellings & renovations, make sure the pipes are thoroughly flushed before connecting**)

**IMPORTANT: When mounting onto bench top. Make sure the fixing kit is tight and mounted from underneath to a Moisture Resistant Board that is flat & level, or directly to the underside of the bench top material. MDF board is not suitable.**

## MOUNTING INSTRUCTIONS FOR CONCEALED SHOWER AND BATH MIXER

In brick veneer/ timber constructions the mixer should be mounted with copper saddle clamps. In solid brick constructions the mixer can be cemented into position. When installing the mixer ensure the hot indicator is to the left when facing the mixer.

The bath shower mixer with diverter should be mounted with the diverter button to the top and the 3/4" outlet to the bottom. Distance from centre line of the inlets to the outside of the finished wall should be between:

Shower mixer: 20mm - 40mm

Shower mixer with diverter: 25mm - 48mm

Silicon should be used to make a seal between the mixer body and the external wall.

When fitting the handle, ensure that the grub screw (requires 3mm allen key) lines up with the round indentation on the plastic hexagon piece.

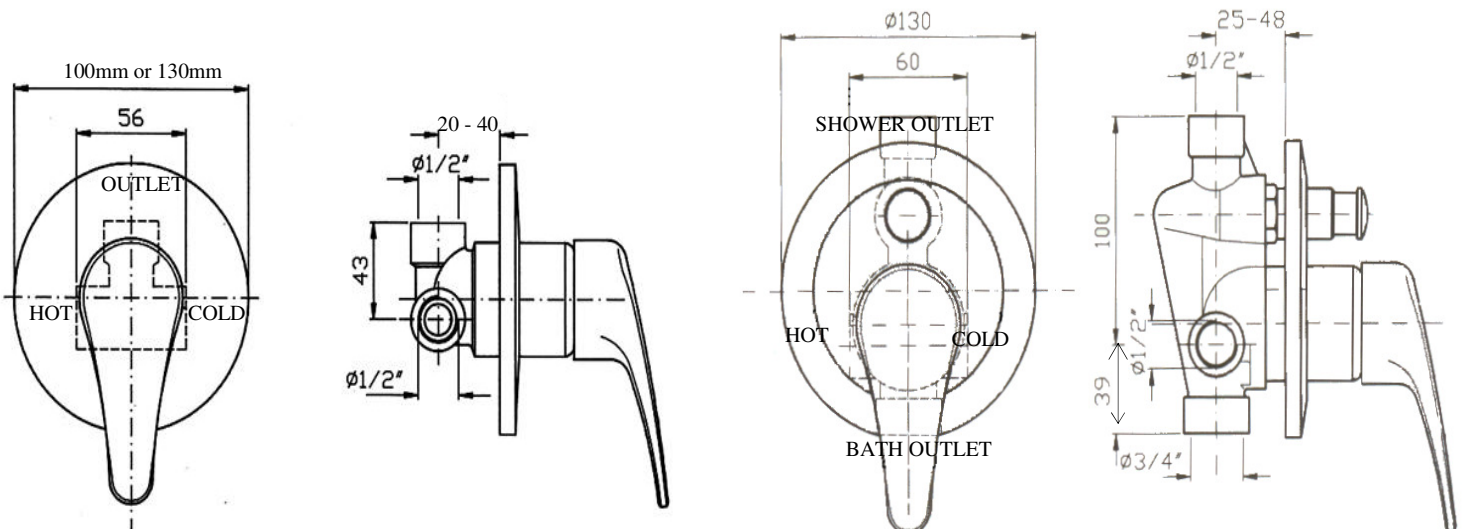

# CARTRIDGE REPLACEMENT INSTRUCTIONS

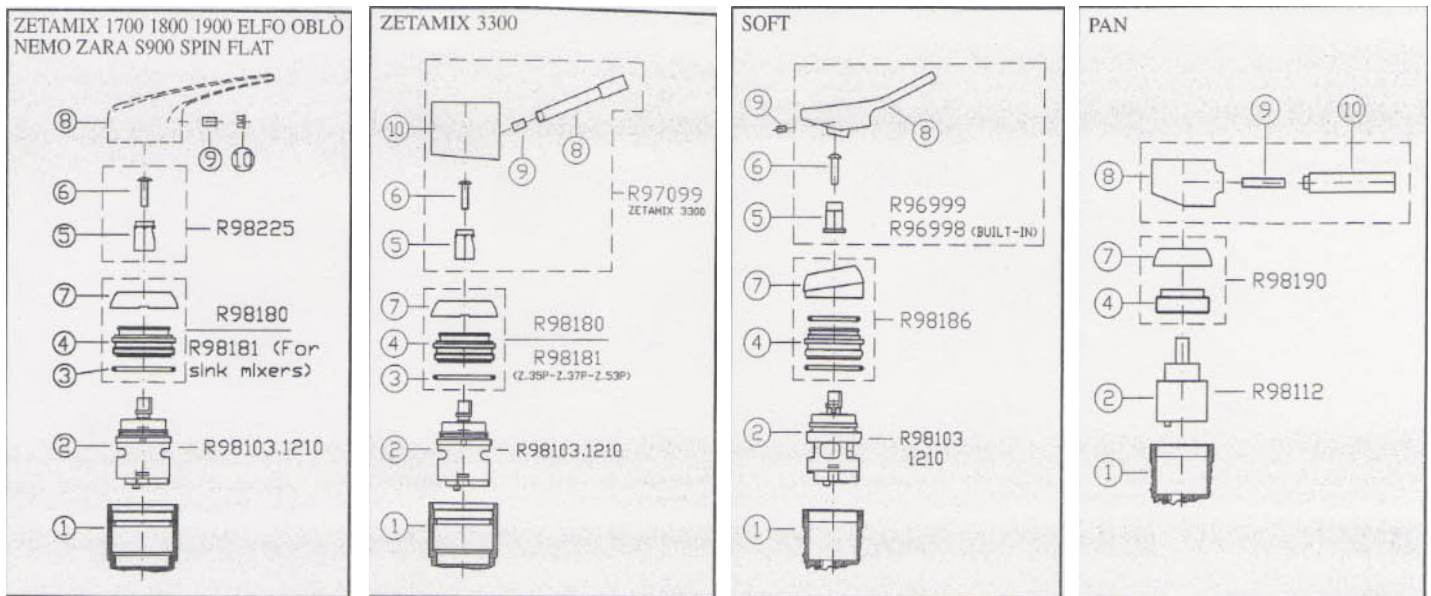

## CARTRIDGE REMOVAL

1. Turn off water at meter, then turn on garden tap to release pressure. Turn on mixer to ensure water flow has stopped.

### Zetamix 1700, 1800, 1900, s900, Elfo, Oblo, Nemo, Spin, Flat, Zara

2. Remove red/blue button (10) positioned on front of handle
3. Remove grub screw (9) with 3mm allen key & pull off handle (8)
4. Undo screw (6) and pull off hexagon adaptor piece (5)
5. Lever off the plastic locknut (4) dome (7) using the notch for that purpose.

### Zetamix 3300

2. Unscrew the handle (8) and the screw underneath (9) anticlockwise (with a 3mm allen key).
3. Remove the cap (10) then remove the lock nut cover ring (7) by levering inside the proper notch.
4. Unscrew the screw (6) and remove the plastic adaptor (5).
5. Remove lock nut (4) using a 36mm spanner and remove the old cartridge (2).

### Soft

2. Remove the handle (8) that is fixed in place with grub screw (9) (using a 2.5mm allen key).
3. Unscrew the screw (6) and remove the adapter (5).
4. Remove the ring nut cover (7), Fixed in position by the relative o-ring.
5. Using hex key (provided with tap) remove lock nut & cover plate. (Shower and diverter mixer only)
6. Using a hex key (provided with tap), unscrew the fastening ring nut (4)
7. Next, remove the cartridge (2)

### Pan

2. Unscrew (by hand) the handle (10)
3. Using a 3mm allen key unscrew the dowel (9).
4. Remove the cap (8)
5. Unscrew (by hand) the ring nut cover (7).
6. Using a 30mm spanner, unscrew the ring nut (4) and remove the cartridge (2).

## CARTRIDGE REPLACEMENT

1. Ensure that the rubber seals at the bottom of the cartridge (2) are seated correctly.
2. Ensure inside of tap body (1) is clean.
3. Line up the two lugs on the bottom of the cartridge with the two according holes on the inside bottom of the tap body and insert the cartridge.
4. Screw locking cap (4) back on, nip it tight (nip it with a tightening torque of 10Nm only PAN products). Refit remaining parts in reverse sequence of removal instructions.



STREAMLINE PRODUCTS PTY LTD

ACN 006 543 210

## Contact Us

Phone: Vic/Tas (03) 8545 0690  
All Other States 1300 735 352  
Facsimile: 1300 669 771  
Email (Service) support@streamlineproducts.com.au

Website: www.streamlineproducts.com.au